

# PILOT YOUR STREET LIGHTING EQUIPMENT



## MID Smart remote module DALI

Control of street  
lighting  
+  
Monitoring light  
garlands

## SMART REMOTE MODULE

**MID** is a stand-alone module.

It centralizes **the operating controls** of the street light and the monitoring of the light garlands.

It allows control of light monitoring at any moment (**power reduction, time slots, remote motion detector, constant light flow, ...**).

## INNOVATION

Centralizes all monitoring functions at the base of the mast.

Leaves you free to manage one or more lights.

Offers the same features as on a remote control.

## ADVANTAGES

The smart device of the street light is **accessible**.

Monitoring a group of street lights is **possible at all times either** point to point or in boxes equipped with PLC (Programmable Logical Controller) for all the lights.

The street light's nominal output is **adjustable manually** by a simple pressure on a waterproof push-button on the front face.

The **light garlands** are **controllable**: on, off, operating time.

When the driver is replaced (identical power), **no installation reprogramming is necessary**.

The **MID** module can monitor up to **two DALI remote motion detectors**.

A motion detector can be added to the street light after having installed the **MID**.

## DALI

A 2-wire communication DALI node is used to communicate between the **MID**, the driver and other optional devices such as a motion detector.





With the Smart remote module DALI **MID**

## MANAGE YOUR STREET LIGHTING EASILY

AND CONTROL YOUR ENERGY COSTS\*

Adapt your lighting throughout **the life-time** of your installation

**Easy to use** within your complete range of LED lighting (more programming on DALI drivers except for simple voltage programming)

**The smart device of the light** is stocked in the **MID**

Access to the **MID** is at **the base of the unit**

Charging the program on the light is carried out current **power off in NFC** (Near Field Communication)  
= **no contact** (via smartphone with NFC, PC with antenna NFC)

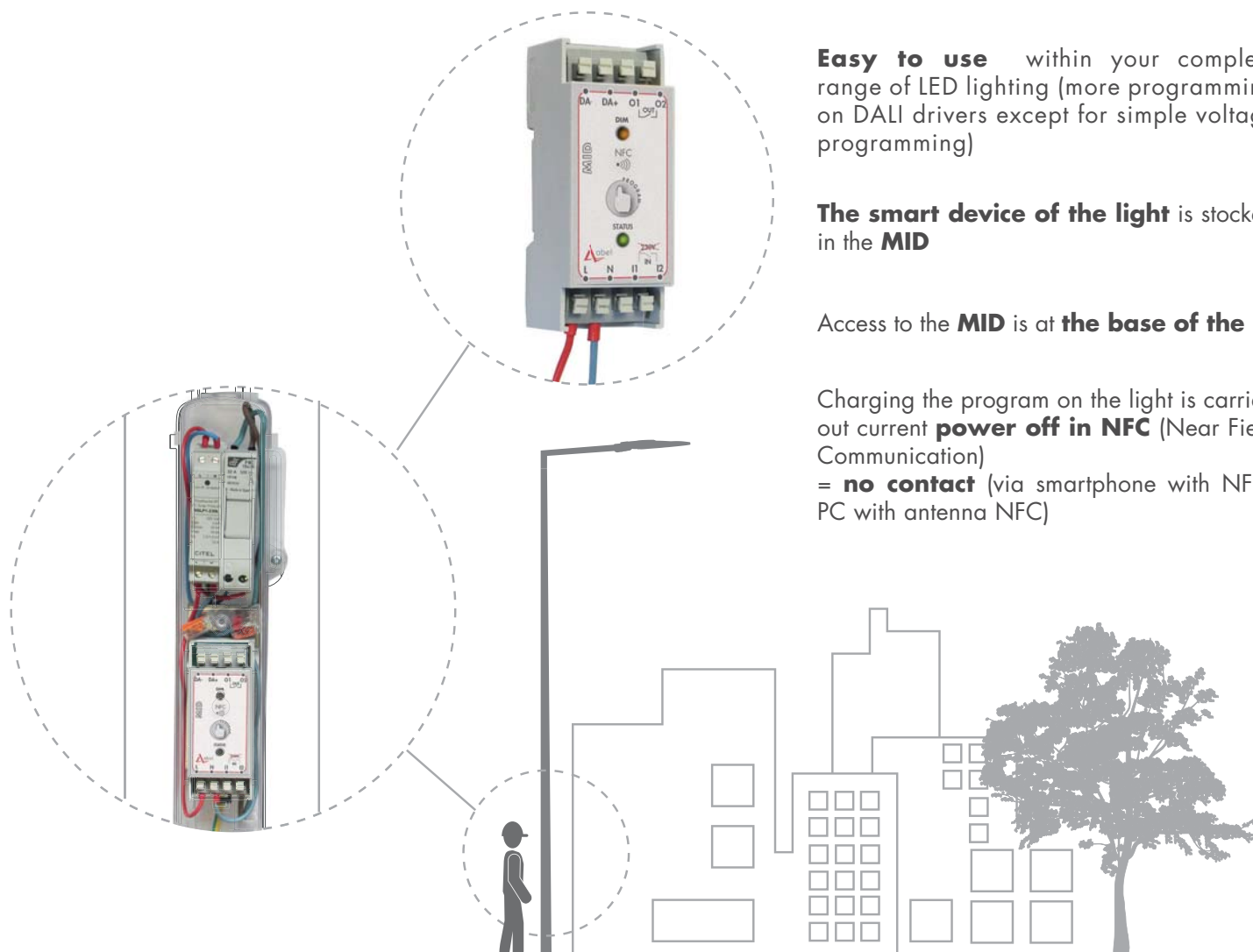

\* simple management of power supply either point to point or from the headend with a PLC.

# PROGRAMMING

4 **MID** programming modes

## Programming by smartphone

Android Application

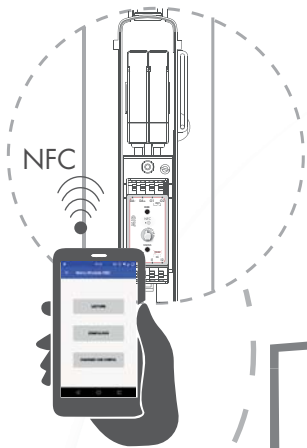

**P-Adjust**  
Power adjustment  
at the light spot



Manual programming on the  
street light

With **MID** powered down  
or

- On-board functions**
- P-Adjust
  - No variation
  - Cycles
  - Timer
  - DALI motion detector
  - Remote Control
  - VAR
  - F-Constant
  - Garland

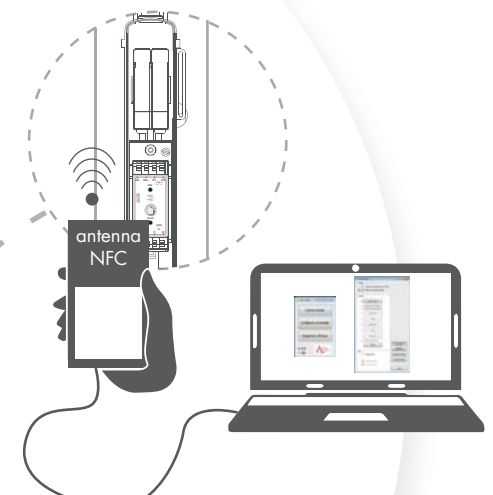

Programming by laptop

## PLC Programming

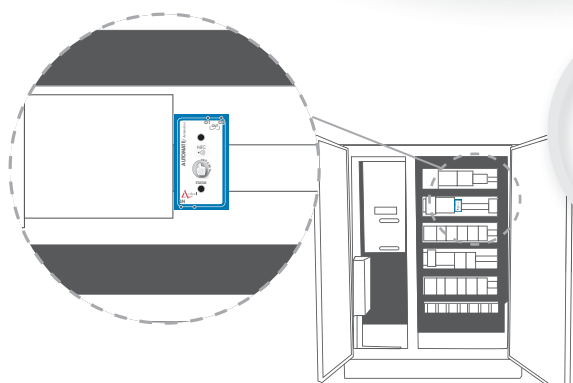

**Group  
programming**

Programming a group of **MID** equipped lights from the  
network head box with **PLC** (Switch Off/On cycles)



# FUNCTIONS



## P-ADJUST

Power setting of lighting to set it at its optimal value



## CYCLES

Light dimming at chosen times



## DALI MOTION DETECTOR

Power setting of lighting according to DALI motion detector



## REMOTE CONTROL

Power setting of lighting according to the order received from other **MID** or other dry contact type systems



## F-CONSTANT

Compensation for the loss of light flow of LEDs



## VAR

Power variation on a group of lights with a head dimmer



## NO VARIATION

The nominal power of the light is steady from switching on to switching off



## TIMER

Power setting of lighting on pre-defined times following switching on



## GARLAND

Switching on and off of a garland according to predefined times after switching on time

Possibility of combining functions.



## SMART LUM

**MID** uses on-board SMART LUM functions, offered by the ABEL LED range



**MID**



**PLC**



**DALI**  
Motion detector

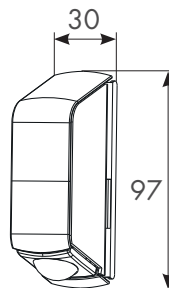

## PRE-REQUISITES FOR INSTALLATION

### NEW

LED Luminaire equipped with a DALI driver 1 cable 5 wires  
Junior connection box or Medium 2-shelved connection box with **MID**, **CC**, lightning arrestor and terminal block.

### EXISTING

LED luminaire equipped with DALI driver 1 cable 5 wires.  
Removal of old connection box to be replaced with a Junior connection box or Medium 2-shelved with **MID**, **CC**, lightning arrestor and terminal block.

## MID RANGE

### Single **MID** module

Junior connection box BD + 1 C/C Ph/N + 1 **MID** module + terminal block B16  
Medium connection box BD + 1 C/C Ph/N + 1 **MID** module + terminal block B50

Junior connection box BD + 1 C/C Ph/N + 1 lightning arrestor + 1 **MID** module + terminal block B16  
Medium connection box BD + 1 C/C Ph/N + 1 lightning arrestor + 1 **MID** module + terminal block B50

Christmas Kit: Medium connection box + 1 C/C + 1 lightning arrestor + 1 Christmas plug + 1 **MID** module

Options

### **PLC**

DALI motion detector

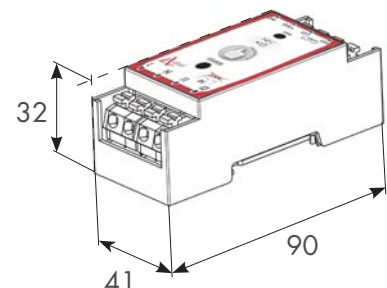

DIN rail mounting



ZI Cana Est - Rue François Labrousse  
B.P. 80005 - 19317 BRIVE Cedex - FRANCE

Tel. : +33 (0)5 55 23 07 90  
Fax : +33 (0)5 55 23 07 91  
[export@abeleclairage.com](mailto:export@abeleclairage.com)

**[www.abeleclairage.com](http://www.abeleclairage.com)**