

VÉRONE



MATERIALS

Bracket: mechanically welded aluminum

SURFACE TREATMENT

Sanded black 2100 color with standard CILLA luminaire
Baked (220°C) polyester powder coating

BRACKET/COLUMN JUNCTION

Adaptable bracket on Ø60 to 76mm (interior Ø48.5mm minimum) columns

Sealing with column by integrated bracket cup
Fastening by pressure screws on the column

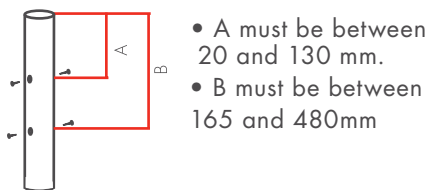

BRACKET/LUMINAIRE JUNCTION

26x34 (1") mounting, female gas screw

Bracket designed for suspended or borne CILLA luminaire

MURAL BRACKET MOUNTING

2 Ø14mm holes for 2 M12 screws
Inter-axial distance 420 mm

OFFSET LIGHT BRACKET MOUNTING

2 supplied M12 screws
Inter-axial distance 420 mm

	L mm	WEIGHT kg	S C X m ²
SINGLE LIGHT	750	5,2	0,09
DOUBLE LIGHT	750	8,1	0,14
MURAL AND OFFSET	500	2,6	0,05
	750	4	0,08
	1000	4,6	0,11

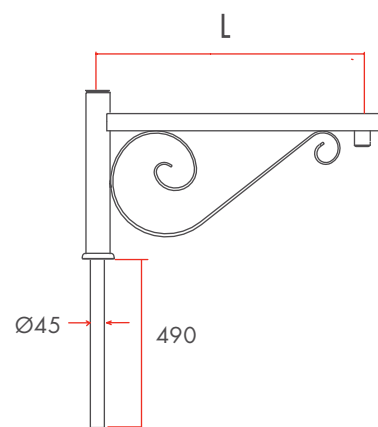

• VÉRONÉ SINGLE LIGHT

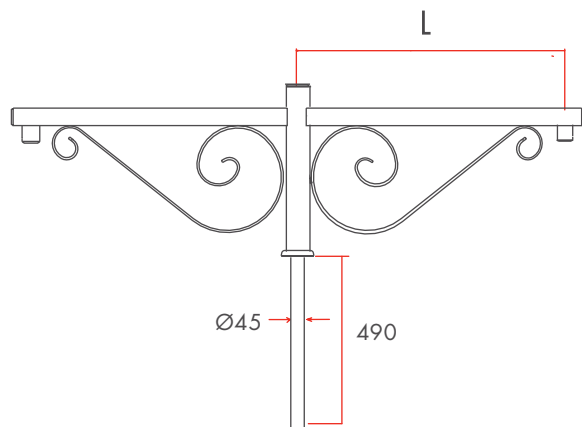

• VÉRONÉ DOUBLE LIGHTS

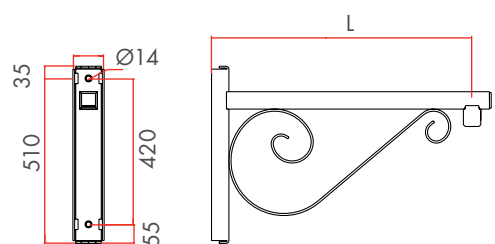

• VÉRONÉ WALL AND OFFSET LIGHTS