



Paceo Top

Design & production
made in France



Their roundness creates
a sober, original range of
luminaires.

3

Paceo top adapts to every environment.

The design is decorated with
easy to match creative detail.



In urban, residential or landscaped living spaces, Pacéo top meets the balance and timelessness challenge.

The luminaire's centred design creates an elegant, balanced pool of light.

Paceo top can be mounted on a bracket or directly on the pole head. The luminaire's head position creates a fluid, rational beam of light.

The light distribution can be adjusted laterally as required.



Paceo top

**The right lighting position,
focused on the essentials.**





The Paceo top luminaire can be fitted with a customisable decorative cut-out to add graphics and visual identity to the lighting.

A unique signature emerges from the urban landscape. The cut-out is a design in its own right that diffuses the light through an interplay of light and shadow.

Shards pattern





The signature design can be customised with the pattern of your choice.

Rectangles
Fans
Cells
Waves

Customisation available from 15 units minimum

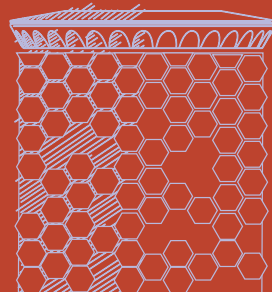
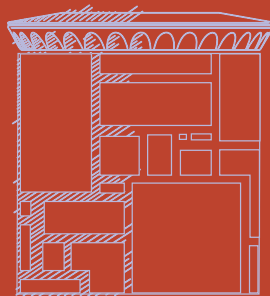

Finish

deco



The clarity of the lines
suggests perfect harmony
in the direct top position.

Elegance and balance

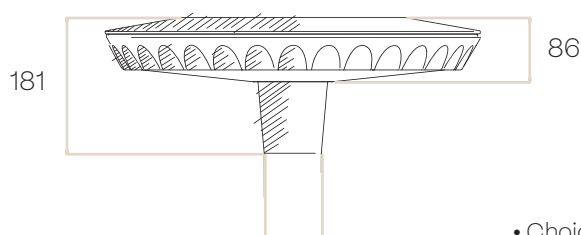

Ø76 exterior
Ø60 interior

- Choice of 5 lenses
- Pre cabled luminaire
- Accessory: male adapter sleeve for Ø76 and Ø89 poles without drilling the pole.

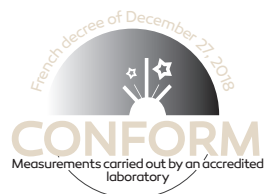
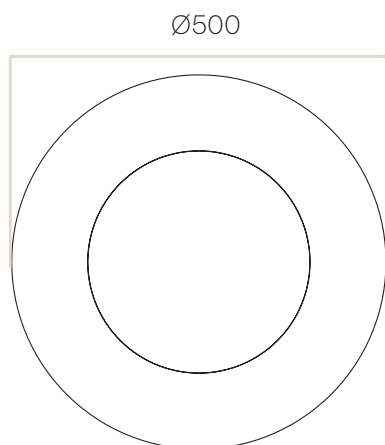



Paceo inspires the
creation of pools of
light that assert their
style.

Architecture and style



As part of architectural designs, the
silhouette reveals clean lines and
adds a touch of modernity.

Dark infrastructure refers to the darkened area of the night sky in which artificial light is dimmed to protect biodiversity.

By creating two-toned amber and white lighting in the same luminaire, Abel shows the interest of harmonising light with its surroundings.

The concept behind Pacey Dark infrastructure is to privilege contrast and colour transitions.

When there is no human activity, the use of amber lighting contributes to respecting nature and the well-being of the species that live in the area.

Respect for biodiversity



The LED colour temperature can be adapted at night to create different lighting moods according to user needs.

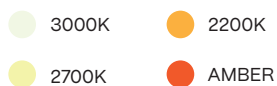

Colour temperature variation:

Tunable white

Variation between 3000K, 2700K, 2200K and Amber depending on the time (no sensor).

Dark infrastructure

Permanent amber and added white when detection is triggered (DALI & MID sensor required).



abel motion sensor integrated into the luminaire.
Remote sensor version available.

Light control

Connected lighting points can be used to define lighting scenarios:

Signals sent from one luminaire to another when presence is detected, dimmed lighting levels in standby mode, remote power and dimming programming, groups of luminaires, etc.

The benefits of abel:

Compatible with DALI,

DALI2 or D4i RGBW or

Tunable white drivers.

Up to 6 DALI devices

(drivers, DALI inputs, DALI

outputs, etc.)

Dry contact or D4i sensors.

A connected, smart luminaire.

Possible functions:

GPS

Energy saving

Group operation

Light wave type dynamic lighting

Maintenance reports

The communication nodes and motion sensors are easy to connect on demand to luminaires fitted with Zhaga connectors.

Gateways, cloud servers, applications and monitoring software complete this network to control the lighting.

Zhaga base to connect a communication node



Driver D4i

Zhaga base to connect a Zhaga sensor



G-node, abel communication node



Connector
Zhaga

4 standardised points
Small footprint

Full technical documentation is available on our www.abeclairage.com website.

Non-contractual photographs | September 2023 edition

Photographs: ©R-Ramshorn, ©X-Boymond, ©Adobe Stock, ©Unsplash



Design & production made in France
in our Brive-la-Gaillarde workshops.

ABEL | ZI CANA EST
Rue François Labrousse

B.P. 70004
19317 Brive-la-Gaillarde
Cedex — FRANCE

Tel. : +33 (0)5 55 23 07 90

abel.brive@abeleclairage.com
www.abeleclairage.com

