

# PhotoLight CURVE 7M



## OVERALL INFORMATION

Dimensions	H 7000 x W 250 x D 1530
Luminaire weight without batteries	150 kg
Material and paint treatment	Aluminum pole and arm - Powder paint (seafront and seaside on request)
Max Power	38W for 1 module
Nominal power	20W for 1 module
Implementation of a surge arrester	Category Electronic Equipment > IV

## LED

Lifetime	L80 > 50 000 hours @700mA @Tq=25°C L70 > 60 000 hours @500mA @Ta=55°C
Manufacturer	LUMILEDS
Lumen/Watt efficiency/Color T°	See PhotoLight range synoptic

## LIGHTING

Outgoing nominal flow Optical performance Luminaire nominal efficiency Optics	} See PhotoLight range synoptic
--	---------------------------------

## BATTERY

### NIMH technology

Protection index	IP66
Battery weight	9 kg or 18 kg
Total power	528 Wh or 1056 Wh
Voltage / Nominal capacity	24V/22 Ah or 24V/44Ah
Nominal lifetime	10 years

## PHOTOVOLTAIC PANELS

Number of panels - Technology	7 - Monocrystalline
Unit power	39W
Voltage	36V
IK panels	IK08

## PROGRAMMING OF YOUR CHOICE

1 - **SMART LUM DIALOG** = configurable in the factory on demand or on site

## WIFI GPS

**Wireless** connection to the lighting point allowing autonomous management. Programming of a luminaire, then dispatch of parameters by radio (zigbee) via **GPS** to all the luminaires in the same group.

## WEB INTERFACE

**Autonomous** mode: the light turns on at dusk and turns off at dawn. Three time periods (beginning, middle, end of night) are available to set lighting power level.  
**Schedule** mode: the lighting power level is defined hour by hour.  
**Smart dimming**: the lighting power level automatically adjusts to last all night.  
**Detect**: activates street lighting, creates a lighting path, allows the synchronization of a group of luminaires after motion detection.  
**On/Off (blackout)**: specific command to intervene directly on the lighting.

2 - **SMART LUM** = factory configured on demand

## DETECT PROG CYCLES

Activates street lighting after motion detection.  
Light dimming at selected times.

## ELECTRONIC CARD

### SMART LUM DIALOG

### SMART LUM

Battery Management (BMS)	Yes	Yes
Solar Charger	Yes	Yes
Communication	WIFI and ZIGBEE	-
Date and time setting	by GPS	-
Movement detector	High-frequency, detection up to 10m	High-frequency, detection up to 10m

 Made in France

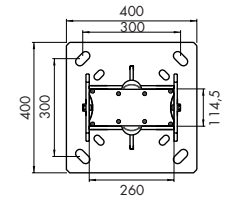
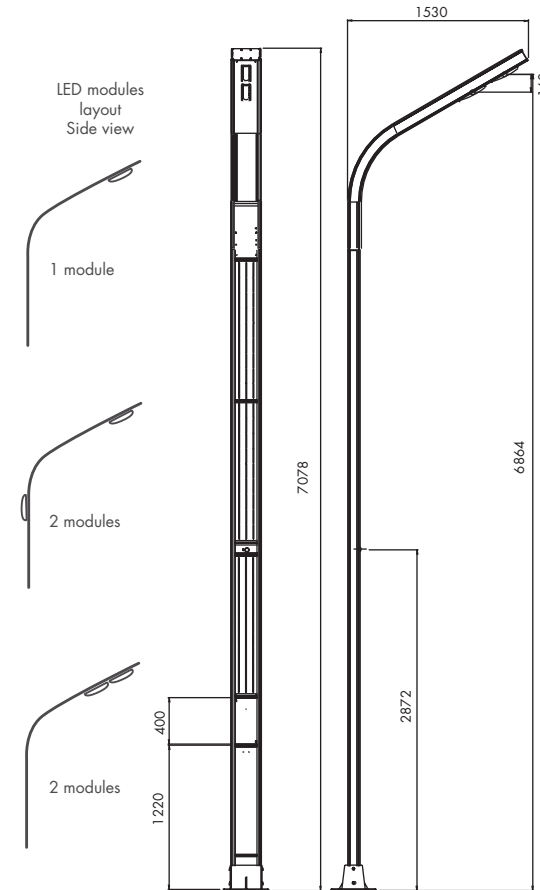

## Photometric curves

ASYM 2-2 optics

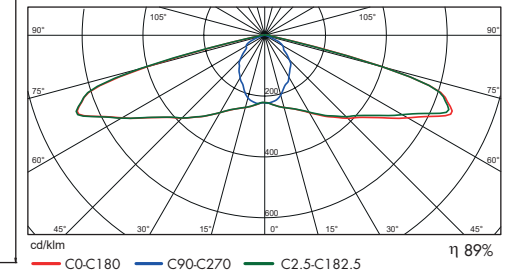

## COMPLIANCE

Standards and certifications	EN 60598-1 / 2-3 Lighting: General requirements and tests - Public lighting luminaires EN 62722-2-1 Performance of luminaires: Requirements for LED luminaires UTE C15-712-2 Practical guide - Stand-alone photovoltaic installations not connected to the public distribution network with battery storage EN 40-6 Specification for aluminum public lighting candelabra
------------------------------	--

## OPERATING TEMPERATURE

Operating temperature range: -20°C to 80°C

## INSTALLATION

Means of installation	Sealing rods not provided, specific according to the wind area
Location of the battery	See installation instructions Inside the pole as standard

## AUTONOMY

According to location and orientation of the luminaire - See table of use