

STRAIGHT 4.60M LED MODULE

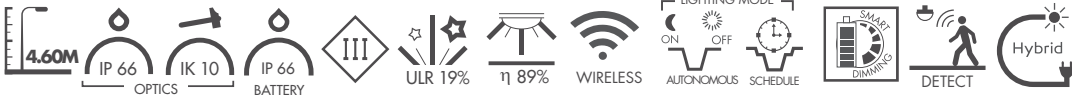

OVERALL INFORMATION

Dimensions	H 4600 x W 250 x D 110
Luminaire weight without battery	95 kg
Material and paint treatment	Aluminum pole and arm - Powder paint (seafront and seaside on request)
Max Power	38W for 1 module
Nominal power	20W for 1 module
Implementation of a surge arrester	Category Electronic Equipment > IV

LED	
Lifetime	L80 > 50 000 hours @700mA @Tq=25°C L70 > 60 000 hours @500mA @Ta=55°C
Manufacturer	LUMILEDS
Lumen/Watt efficiency/Color T°	See PhotoLight range synoptic

LIGHTING	
Outgoing nominal flow Optical performance Luminaire nominal efficiency Optics	See PhotoLight range synoptic

BATTERY	
NIMH technology	
Protection index	IP66
Battery weight	5 kg or 9kg
Total power	264 Wh or 528 Wh
Voltage / Nominal capacity	12V/22 Ah or 24V/22Ah
Nominal lifetime	10 years

PHOTOVOLTAIC PANELS	
Number of panels - Technology	4 - Monocrystalline
Unit power	39W
Voltage	36V
IK panels	IK08

PROGRAMMING OF YOUR CHOICE 1 - **SMART LUM DIALOG** = configurable in the factory on demand or on site

WIFI GPS **Wireless** connection to the lighting point allowing autonomous management. Programming of a luminaire, then dispatch of parameters by radio (zigbee) via **GPS** to all the luminaires in the same group.

WEB INTERFACE **Autonomous** mode: the light turns on at dusk and turns off at dawn. Three time periods (beginning, middle, end of night) are available to set lighting power level. **Schedule** mode: the lighting power level is defined hour by hour. **Smart dimming**: the lighting power level automatically adjusts to last all night. **Detect**: activates street lighting, creates a lighting path, allows the synchronization of a group of luminaires after motion detection. **On/Off (blackout)**: specific command to intervene directly on the lighting.

2 - **SMART LUM** = factory configured on demand

DETECT PROG CYCLES Activates street lighting after motion detection. Light dimming at selected times.

ELECTRONIC CARD	SMART LUM DIALOG	SMART LUM
Battery Management (BMS)	Yes	Yes
Solar Charger	Yes	Yes
Communication	WIFI and ZIGBEE	-
Date and time setting	by GPS	-
Movement detector	High-frequency, detection up to 10m	High-frequency, detection up to 10m

Made in France



LED modules layout Side view



1 module

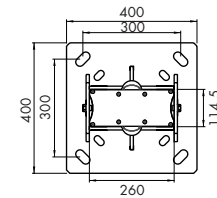
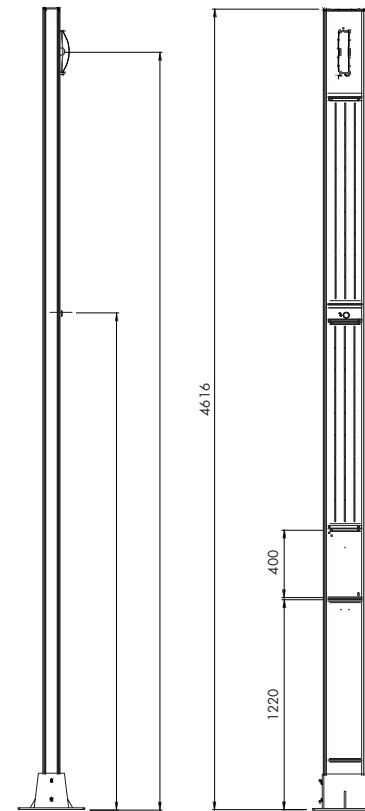

Photometric curves

ASYM 2-2 optics

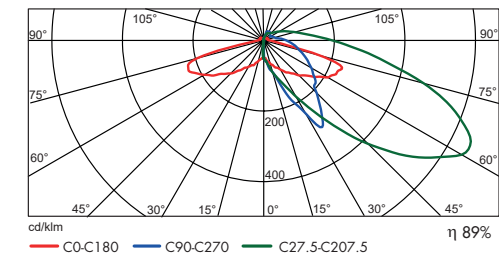

COMPLIANCE	
Standards and certifications	EN 60598-1 / 2-3 Lighting: General requirements and tests - Public lighting luminaires EN 62722-2-1 Performance of luminaires: Requirements for LED luminaires UTE C15-712-2 Practical guide - Stand-alone photovoltaic installations not connected to the public distribution network with battery storage EN 40-6 Specification for aluminum public lighting candelabra
OPERATING TEMPERATURE	
	Operating temperature range: -20°C to 80°C
INSTALLATION	
Means of installation	Sealing rods not provided, specific according to the wind area
Location of the battery	See installation instructions Inside the pole as standard
AUTONOMY	
	According to location and orientation of the luminaire - See table of use