

STRAIGHT 7M LED MODULE

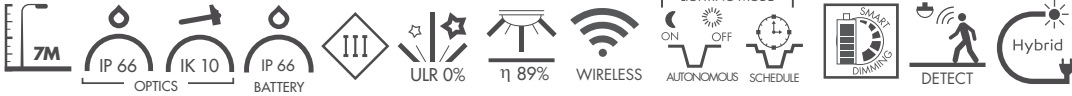

OVERALL INFORMATION

Dimensions	H 7000 x W 250 x D 110
Luminaire weight without battery	135 kg
Material and paint treatment	Aluminum pole and arm - Powder paint (seafront and seaside on request)
Max Power	38W for 1 module
Nominal power	20W for 1 module
Implementation of a surge arrester	Category Electronic Equipment > IV

LED

Lifetime	L80 > 50 000 hours @700mA @Tq=25°C L70 > 60 000 hours @500mA @Ta=55°C
Manufacturer	LUMILEDS
Lumen/Watt efficiency/Color T°	See PhotoLight range synoptic

LIGHTING

Outgoing nominal flow Optical performance Luminaire nominal efficiency Optics	} See PhotoLight range synoptic
--	---------------------------------

BATTERY

NIMH technology

Protection index	IP66
Battery weight	9 kg or 18 kg
Total power	528 Wh or 1056 Wh
Voltage / Nominal capacity	24V/22 Ah or 24V/44Ah
Nominal lifetime	10 years

PHOTOVOLTAIC PANELS

Number of panels - Technology	8 - Monocrystalline
Unit power	39W
Voltage	36V
IK panels	IK08

PROGRAMMING OF YOUR CHOICE

1 - SMART LUM DIALOG = configurable in the factory on demand or on site

WIFI GPS

Wireless connection to the lighting point allowing autonomous management. Programming of a luminaire, then dispatch of parameters by radio (zigbee) via **GPS** to all the luminaires in the same group.

WEB INTERFACE

Autonomous mode: the light turns on at dusk and turns off at dawn. Three time periods (beginning, middle, end of night) are available to set lighting power level.
Schedule mode: the lighting power level is defined hour by hour.
Smart dimming: the lighting power level automatically adjusts to last all night.
Detect: activates street lighting, creates a lighting path, allows the synchronization of a group of luminaires after motion detection.
On/Off (blackout): specific command to intervene directly on the lighting.

2 - SMART LUM = factory configured on demand

DETECT PROG CYCLES

Activates street lighting after motion detection.
Light dimming at selected times.

ELECTRONIC CARD

SMART LUM DIALOG

SMART LUM

Battery Management (BMS)	Yes	Yes
Solar Charger	Yes	Yes
Communication	WIFI and ZIGBEE	-
Date and time setting	by GPS	-
Movement detector	High-frequency, detection up to 10m	High-frequency, detection up to 10m

Made in France



LED modules layout
Side view



1 module



2 modules



2 modules

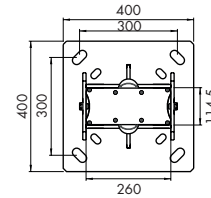
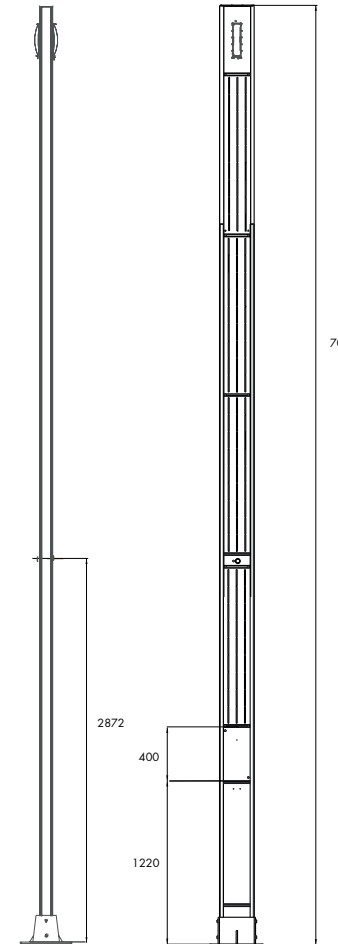

Photometric curves

ASYM 2-2 optics

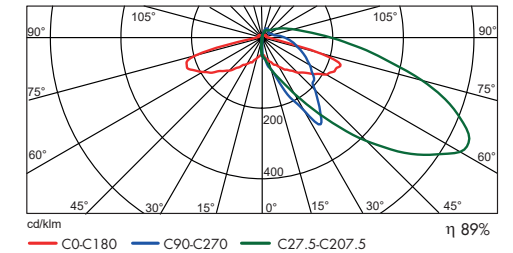

COMPLIANCE

Standards and certifications	EN 60598-1 / 2-3 Lighting: General requirements and tests - Public lighting luminaires EN 62722-2-1 Performance of luminaires: Requirements for LED luminaires UTE C15-712-2 Practical guide - Stand-alone photovoltaic installations not connected to the public distribution network with battery storage EN 40-6 Specification for aluminum public lighting candelabra
------------------------------	--

OPERATING TEMPERATURE

Operating temperature range: -20°C to 80°C

INSTALLATION

Means of installation	Sealing rods not provided, specific according to the wind area
Location of the battery	See installation instructions Inside the pole as standard

AUTONOMY

According to location and orientation of the luminaire - See table of use